

## Bethpage Presbyterian Church

### Educational Building - Top Floor (300s)

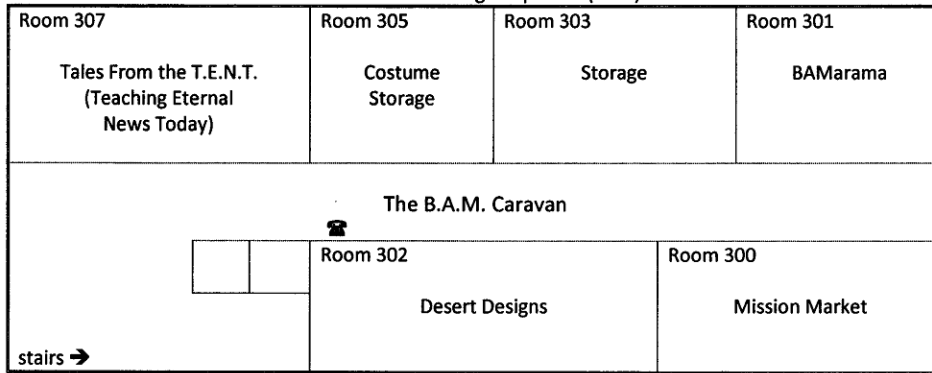

### Educational Building - Ground Floor (200s)

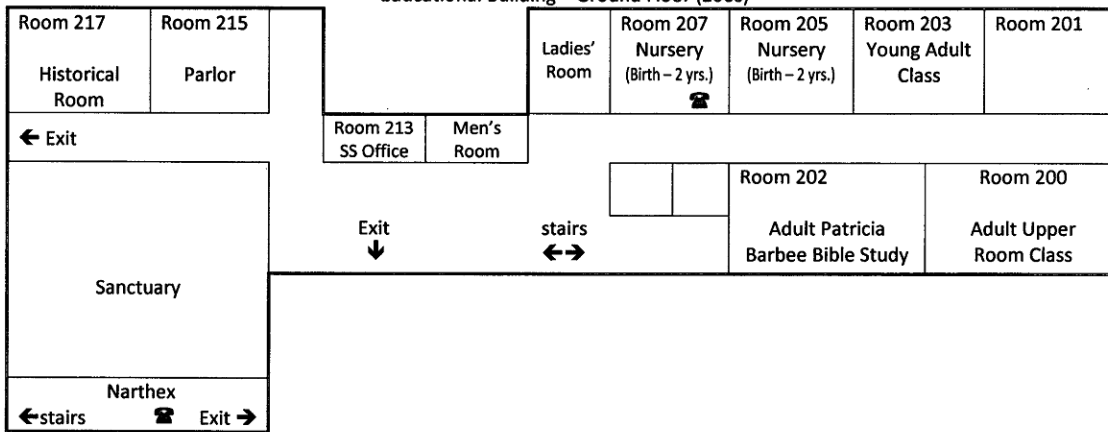

### Educational Building - Basement Area (100s)

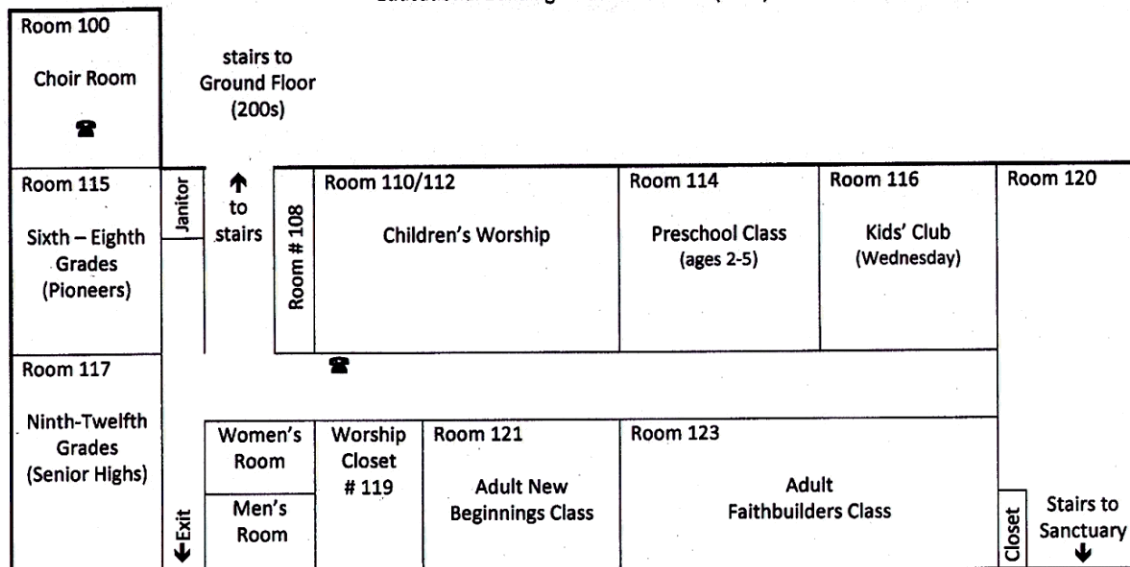

# The Sunday School

of  
Bethpage  
Presbyterian Church  
welcomes you!



B.A.M. Caravan starts at 9:45 AM  
All other classes start at 10:00 AM

6020 Mooresville Road  
Kannapolis, North Carolina 28081  
phone: 704-933-2209 fax: 704-933-2208  
[www.bethpagechurch.org](http://www.bethpagechurch.org)  
[info@bethpagechurch.org](mailto:info@bethpagechurch.org)

Rev. Rick Hoffarth, Pastor  
Angie Fansler, Director of Christian Education

## Infants through Fifth-Graders

### Nursery (ages birth – 2 years)..... Rooms 205 & 207

Bethpage provides a safe and loving nursery facility. Excellent nursery care is provided for the smallest of our community.

### Preschool (ages 2 – 5) .....Room 114

2- through 5-year-olds are invited to creatively experience God's Word in age-appropriate ways within a safe learning environment using the Rock Solid curriculum.

### Kindergarten – Fifth Grades

.....Rooms 300, 301, 302, 307

Elementary ages learn in The B.A.M. (Bible And Me) Caravan using workshop rotation. Each month they learn about one Bible story in a variety of ways. Children are encouraged to dig deep into God's Word by concentrating on one story for a longer period of time through several different media.

## Youth

### Sixth-Eighth Grades.....Room 115

Middle Highs expand their understanding of Bible stories through discussion and Bible skills using age-appropriate curriculum.

### Ninth-Twelfth Grades .....Room 117

Through fellowship, open discussion, and discovery, Senior Highs explore contemporary issues related to living a faithful Christian life using a variety of video and print curriculum.

## Adults

### Young Adults .....Room 203

This class involves college students and young singles in an opportunity to learn how God's Word relates to their everyday lives.

### New Beginnings Class.....Room 121

This is a discussion based class with shared leadership and a variety of short term studies including video based studies, book studies, topical and occasional single week studies – always seeking Biblical application and insight through these study forms. Includes middle adults, married and single.

### Faithbuilders Class .....Room 123

Open discussion format using contemporary studies on all aspects of the Bible and how it relates to our daily lives. Includes parents of young children and teens.

### Open Class .....Room 400

In Church Office Building

This class studies the Uniform lesson using class discussion and participation. Includes active middle and older adults.

### Patricia Barbee Bible Study .....Room 202

Studies individual books of the Bible in detail to get a better understanding of how it is applied to today's life. Includes adults of differing ages.

### Upper Room Class.....Room 200

This class has a formal presentation of the Uniform lesson, and shares expressions of their common concerns in the faith community. Includes adults with grown children and grandchildren.

*Come as our guest,  
Leave as our friend!*

